



# ARCHER 1200 BARRIER ANTI VEHICLE BARRIER



11 Boeing Place, Mount Maunganui 3116 Ph: 07 575 0505  
2/11 March Place, Belfast, Christchurch 8051 Ph: 03 323 7507  
Email: [admin@trafficsigns.co.nz](mailto:admin@trafficsigns.co.nz) [www.trafficsigns.co.nz](http://www.trafficsigns.co.nz) PO Box 4366, Mount Maunganui South 3149

## Making People, Communities & Places Safer

- Strongest mobile barrier in the world
- Single person deployment
- No forklift or crane needed
- None mechanical
- Crash Test Certified
- Protection for people and crowds at events
- Permits free flowing access for pedestrian and emergency vehicles
- Australian Made

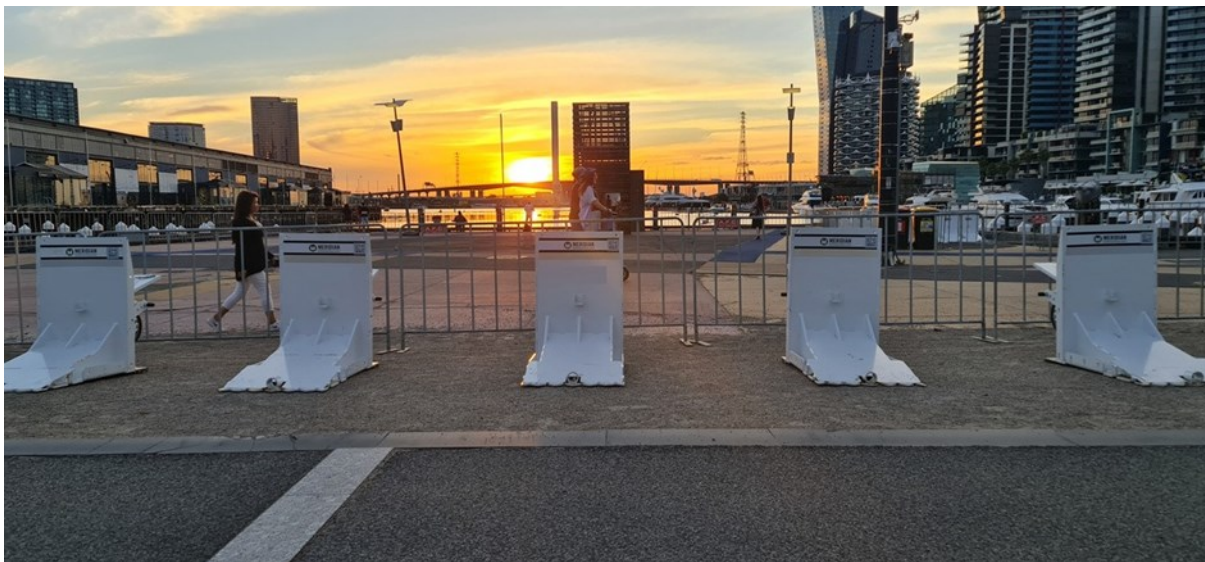
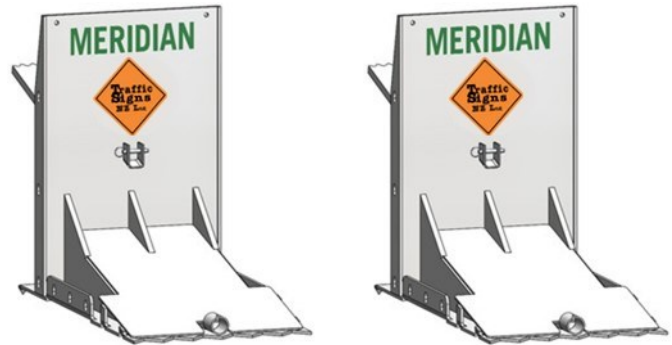

**Contact Ricky Foster**

**M: 027 464 7768**

**[ricky@trafficsigns.co.nz](mailto:ricky@trafficsigns.co.nz)**



# ARCHER RAPID GATE



11 Boeing Place, Mount Maunganui 3116 Ph: 07 575 0505  
2/11 March Place, Belfast, Christchurch 8051 Ph: 03 323 7507

Email: [admin@trafficsigns.co.nz](mailto:admin@trafficsigns.co.nz) [www.trafficsigns.co.nz](http://www.trafficsigns.co.nz) PO Box 4366, Mount Maunganui South 3149

## Rapid Gate Net Available in 3m, 3.8m and 4.4m

### PRODUCT FEATURES

### SPECIFICATIONS

### ACCESSORIES

Lifetime warranty

No Hydraulics, No Electricity

One person deployment

180 Degree Rotation

No Maintenance

Made in USA

Dimensions [L-5.5 m,  
W-1.2 m, H-1.5 m]

Capability to be  
cabled together.

Wayfinding frames

Directional signage

Archer Hauler

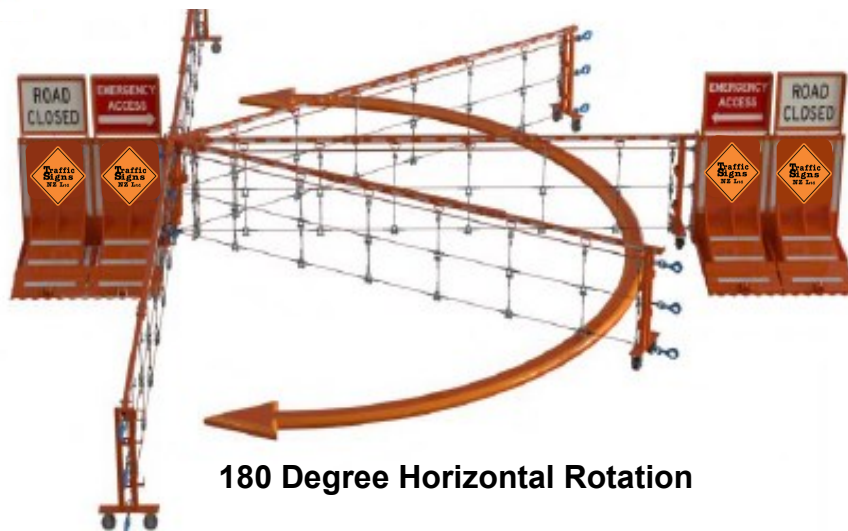
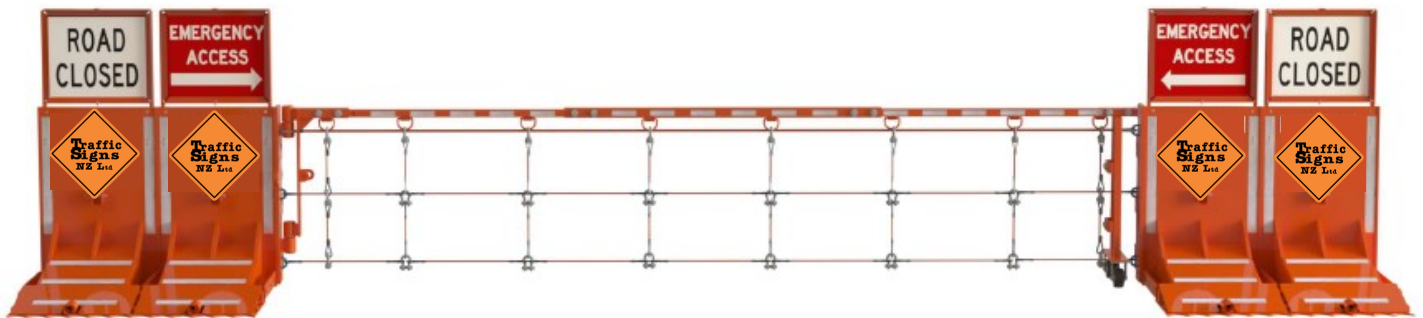

180 Degree Horizontal Rotation